

# Survey Plan

**BENNETT • BENNETT**  
 Property Consultants, Surveyors & Town Planners  
 All mail to: PO Box 1821 (GPO), St. Pauls, Qld. 4075  
 Phone: (07) 3261 2222  
 Fax: (07) 3261 2221  
 Email: [info@bennett-bennett.com.au](mailto:info@bennett-bennett.com.au)

Professional Services:  
 Surveying, Town Planning, Property Valuation, Real Estate, Construction Management, Environmental Assessment, Heritage Assessment, Archaeology, Geomatics, GIS, Drone Operations, etc.

Address: 1/111 St. Pauls Road, St. Pauls, Qld. 4075  
 Phone: (07) 3261 2222  
 Fax: (07) 3261 2221  
 Email: [info@bennett-bennett.com.au](mailto:info@bennett-bennett.com.au)

**NOTES:**

- Drawn to scale as shown.
- Lease area measured in accordance with the P.C.A. measurements for ILLA (Vic. Authority) using OLS 2017.
- The boundaries shown have been compared with the original plan and are shown to be correct.
- Lease boundaries are defined by checked dimensions. Distances shown are indicative only unless noted otherwise.

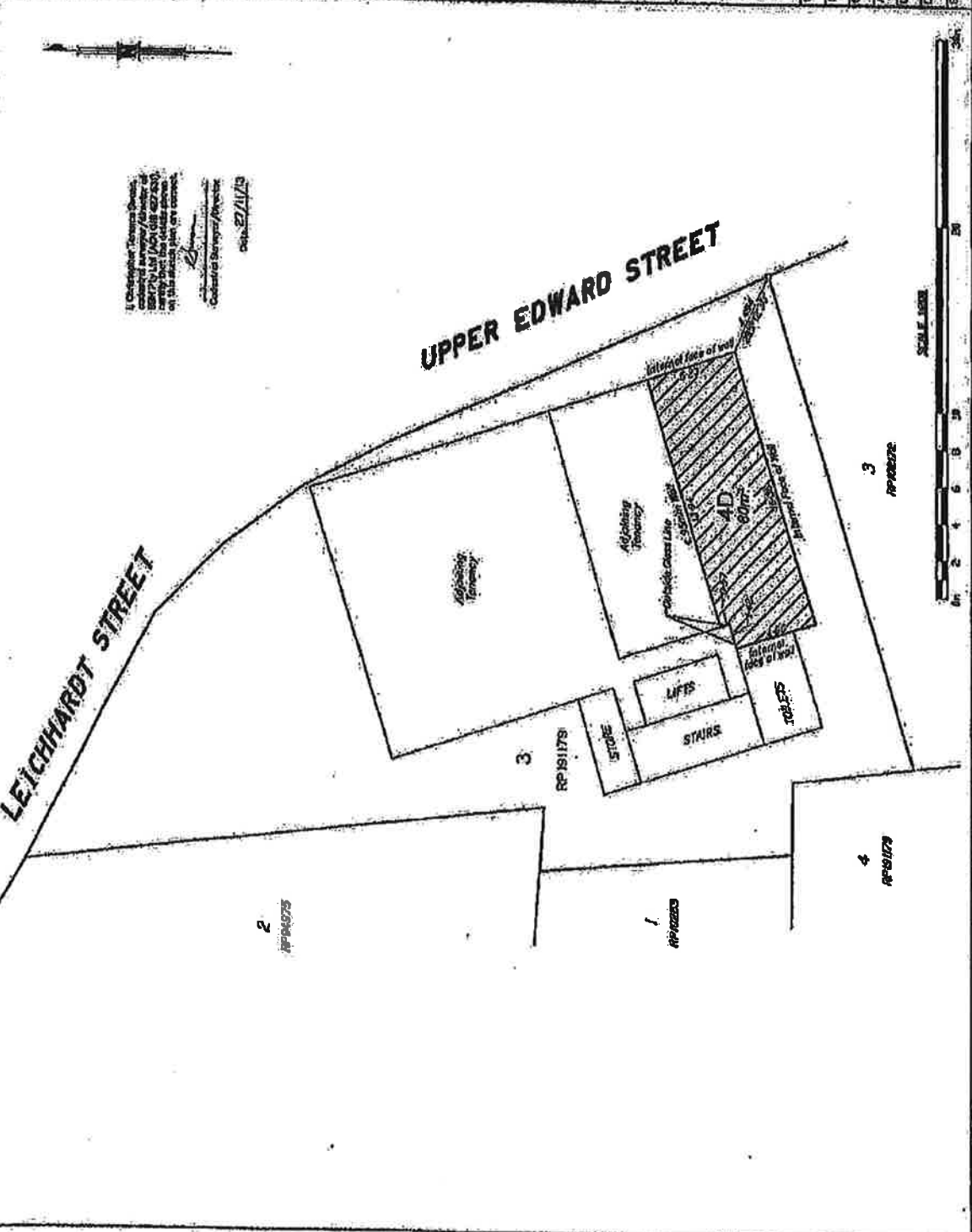

I, the undersigned, being a duly qualified and licensed Surveyor, do hereby certify that this plan is a true and correct copy of the original plan on file in my office.

*[Signature]*  
 Colin Bennett / Partner  
 27/11/20

**TITLE**  
 'PLAN OF LEASE 4D'  
 at 490 Upper Edward St,  
 BRISBANE

being part of the 4th Floor of the building depicted on Lot 3 on RP 191178

**CUSTOMER** Upper Edward Partnership

**Drawn** JSC  
**City** North Brisbane  
**County** STANLEY  
**Authorisation** Job Ref: 052501  
**Checked** JJC  
**Scale** 1:200  
**Date** 28/09/20  
**Drawn** JSC  
**Scale** 1:200  
**Plan No.** 4  
**Rev.** A