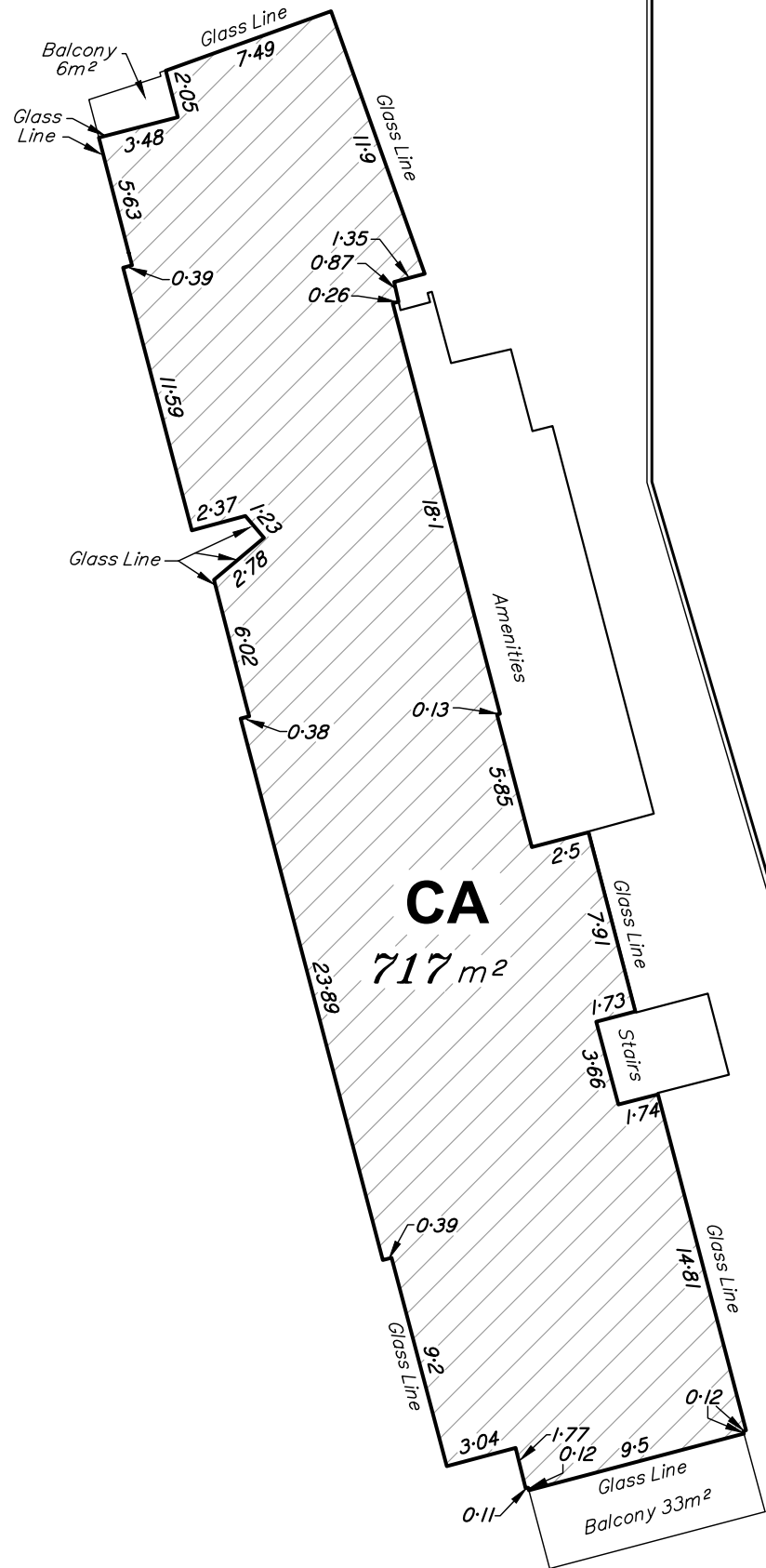
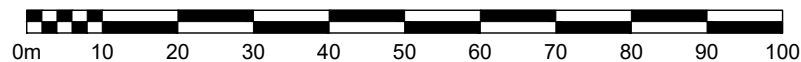

DIAGRAM
Scale 1:300

NOTE: Lease boundaries are the internal face of wall unless noted otherwise.



Scale 1:1000



Sheet 1 of 1

PO Box 5021, GCMC QLD 9726
Ph: (07) 5631 8000
mail@bennettandbennett.com.au

Surveying, Town Planning & Spatial Services
GOLD COAST | BRISBANE | SUNSHINE COAST | NORTHERN RIVERS
www.bennettandbennett.com.au

B.B.H. PTY. LTD. (ACN 010 427 531)
(trading as Bennett and Bennett Group)
certify that the details shown on this sketch plan are correct

Director
Director
Date 22/05/2023

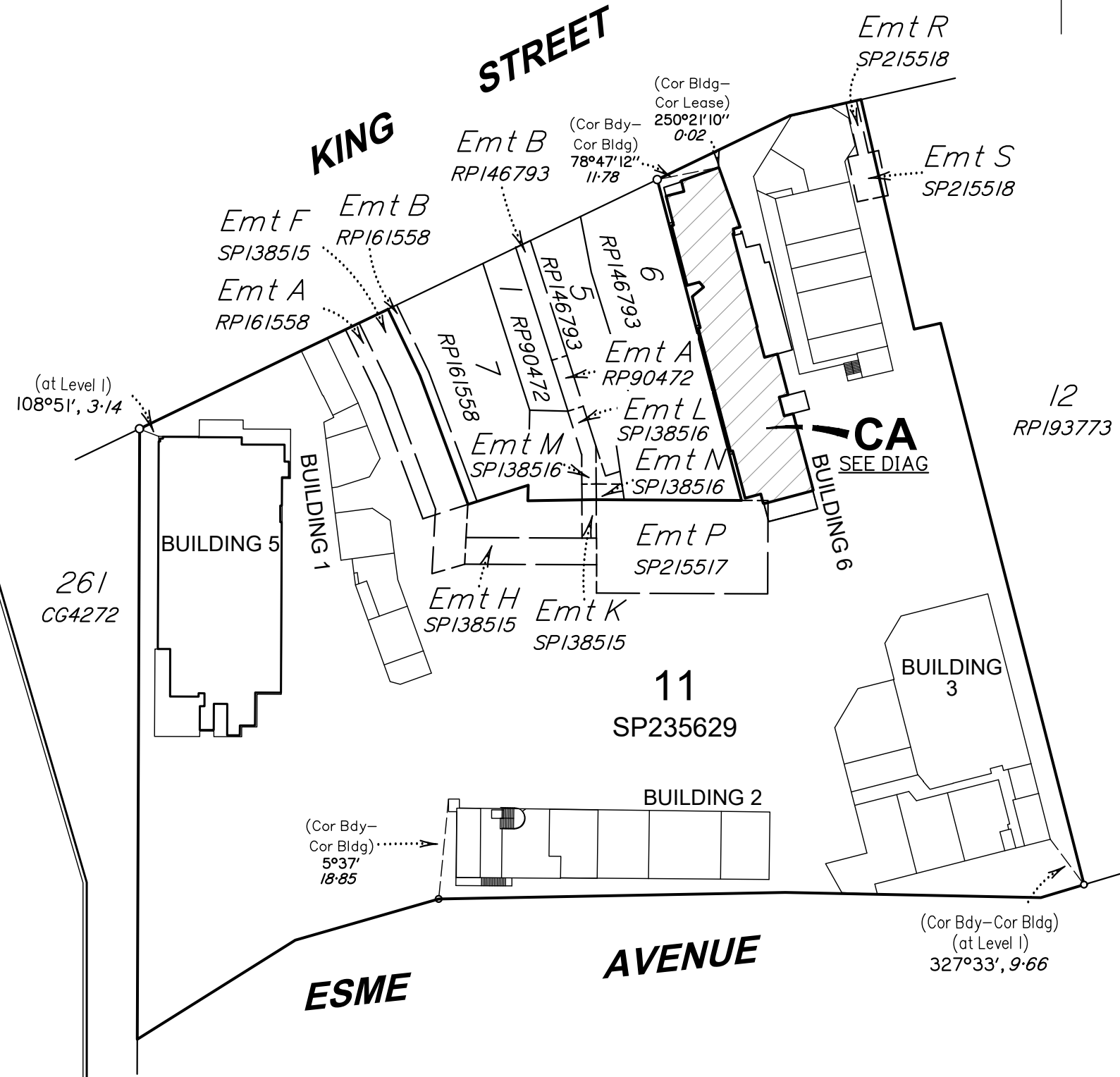
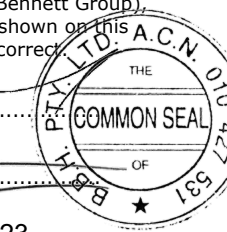

- NOTES:
1. Drawn to scale on A3 sheet.
 2. Lease area measured in accordance with the P.C.A. recommendations for Net Lettable Area. (NLA)
 3. Title Reference : 50820729
 4. Adjoining tenancies shown have been compiled from other sources and are diagrammatic only.
 5. Lease boundaries are defined by structural elements, distances shown are indicative only unless noted otherwise.
 6. Meridian of IS200592

A	Original Issue	AMB	17/05/2023
Issue	Revision	Int	Date

Plan of Lease Area "CA"
being part of Level 2 of the building erected on Lot 11 on SP235629

Client:	DE MARTINI FLETCHER		
Locality:	CABOOLTURE		
Local Gov:	MBRC	Prepared By:	AMB
Surveyed By:	MD	Approved:	KJ
Date Created:	17/05/2023	Scale:	1:1000
Comp File:	200708.PROJECT		
Plan No:	200708_011_LEA		